

Maps and Directions to

Kremblas & Foster

Intellectual Property Law - Patents, Trademarks & Copyrights

7632 Slate Ridge Blvd.

Reynoldsburg, OH 43068

Phone: 614/575-2100

Fax: 614/575-2149

Web Site: www.ohiopatent.com

Our office is at the star on the maps. Take Interstate 70 to State Route 256. It is the second exit east of Interstate 270. Exit at S.R. 256 in the direction marked "Reynoldsburg" and go north on 256 W. Our street, Slate Ridge Blvd., is an extension of Livingston and is 0.9 mile north of Interstate 70 at a traffic light. Turn right onto Slate Ridge Blvd. Our office is the fourth building on the left (the north side of Slate Ridge). Our front door is in the center of the building. Park right in front.

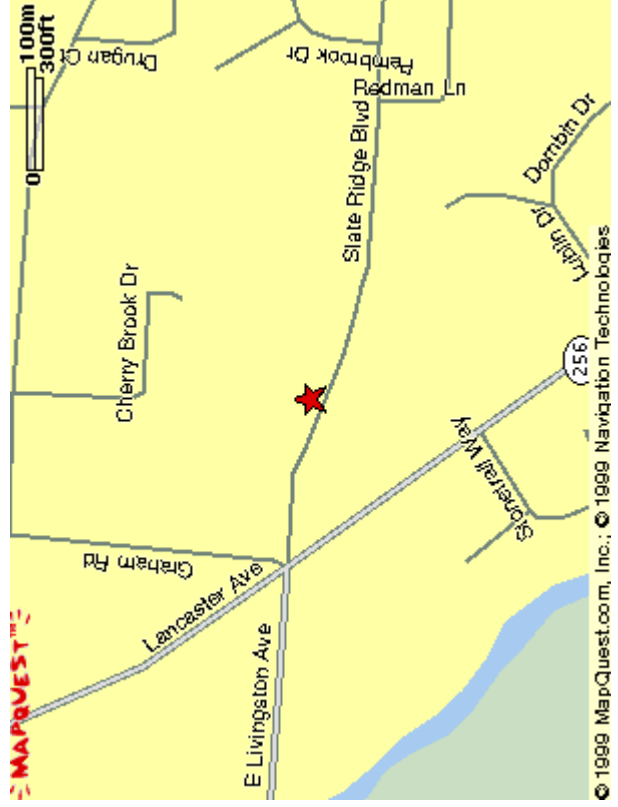
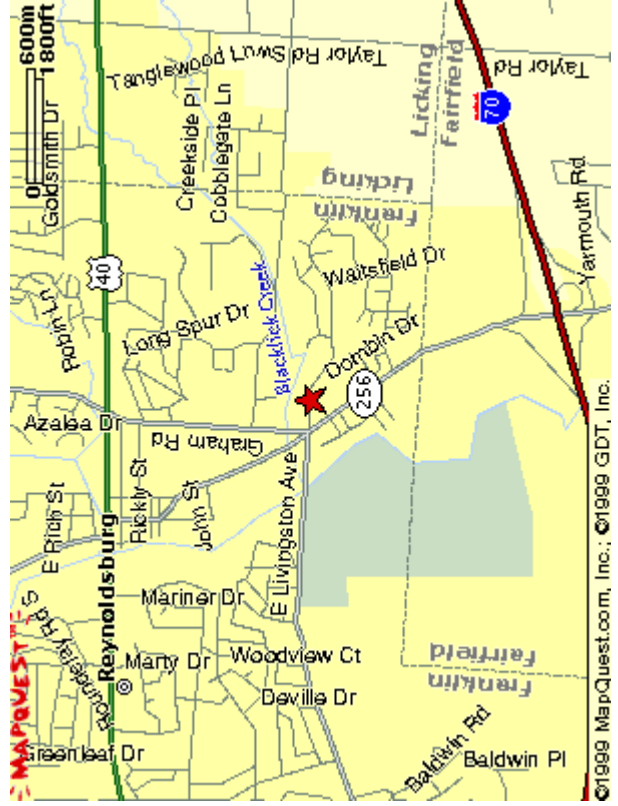

7599 Slate Ridge Blvd

Exit Street View

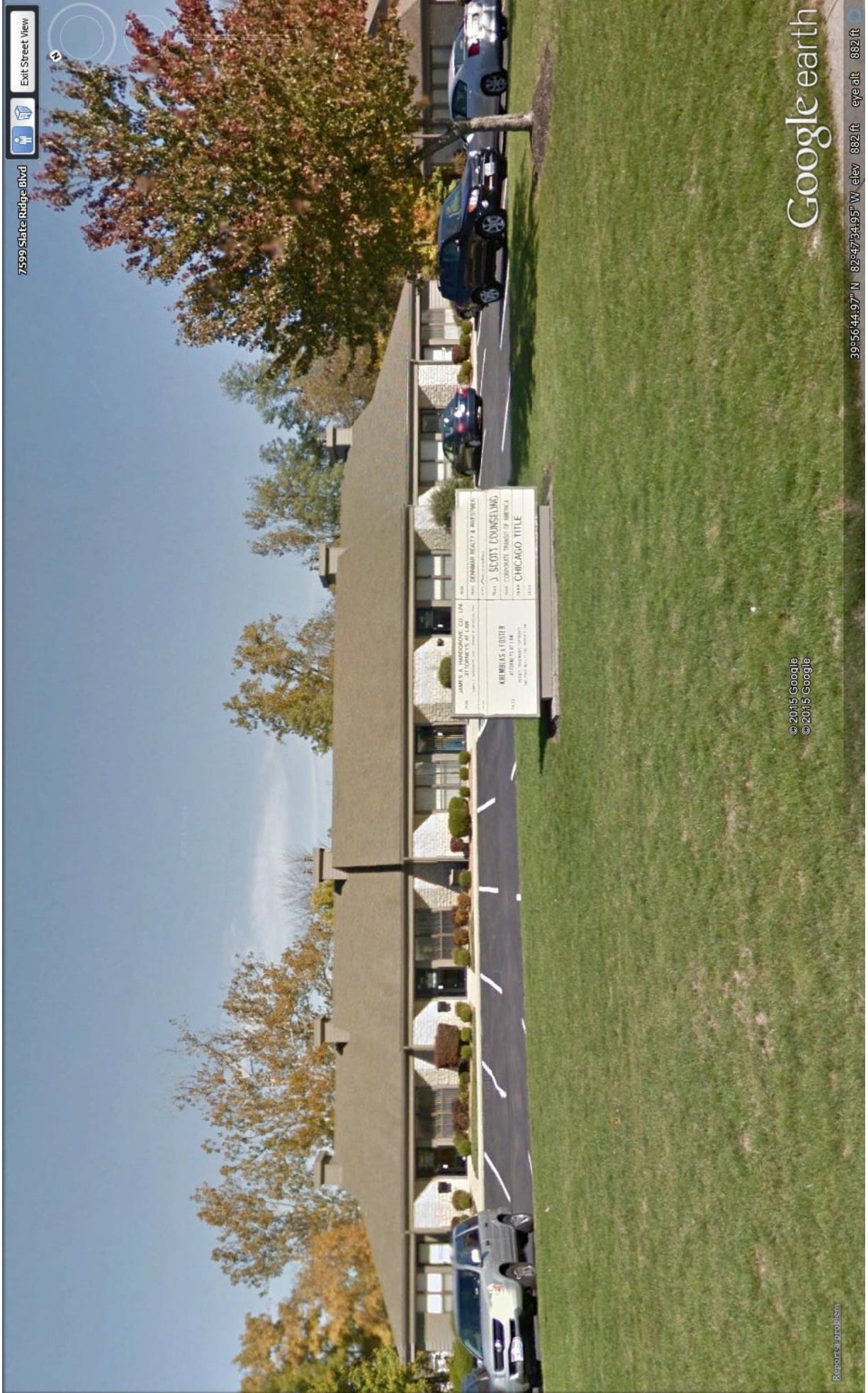

© 2015 Google
© 2015 Google

Report a problem

39°56'44.97" N 82°47'34.95" W elev 882 ft eye alt 882 ft

Google earth